





# Birmingham Road, Shenstone, Lichfield

£425,000

3 2 2





REDUCED TO REFLECT THE NEED FOR SOME TLC! Located in one of the most desirable villages around, this detached home boasts a large garden and a spectacular view over adjoining countryside, so it's sure to be very popular! The property has been extended and offers plenty of space for the money with the accommodation comprising a through entrance hall, lounge diner, family room with bay window, generous kitchen and contemporary ground floor shower room. Upstairs are three bedrooms with the master having a balcony with those fabulous views and a family bathroom. The property benefits from having plenty of parking on the sizable driveway and a gate provides access to the rear garden. The rear is spacious and incorporates a block paved patio, lawn and shed along with countryside views. The property sits within the catchment of the highly desirable Greysbrooke Primary School and really is a must view home. Don't miss out and book in your visit today!

#### Note

Please note, we understand that a small portion of the property's driveway sits on land that has been used by the current owners for some time but is not under legal ownership of the property.



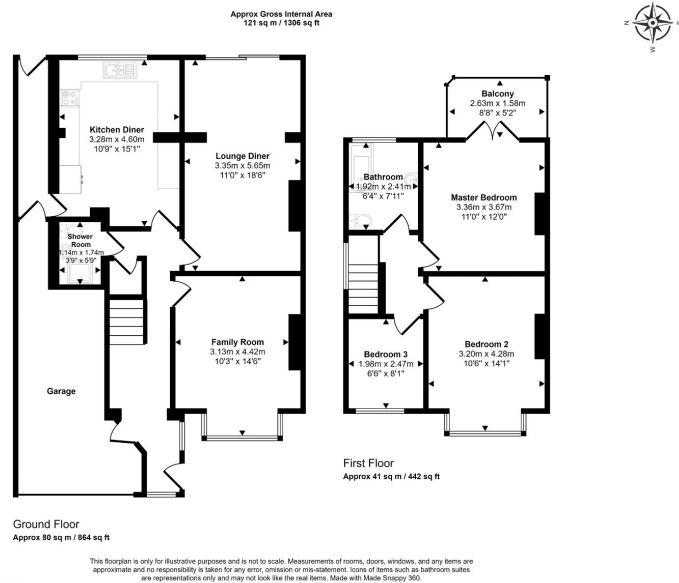

- Three Bedroom Detached Home In The Popular Village Of Shenstone
- Stunning Rural Views To The Rear
- Generous Kitchen, Bathroom & Contemporary Shower Room
- Sitting Within The Highly Desirable Greysbrooke Primary School Catchment
- Extended Lounge Diner & Separate Family Room
- Good Sized Garden, Garage & Large Driveway

